

- PROPRIETARY INFORMATION -  
NO USE OR REPRODUCTION MAY BE MADE OF  
THIS DOCUMENT WITHOUT EXPRESS WRITTEN  
PERMISSION OF NEOCONIX.

REVISIONS			
REV.	DESCRIPTION	DATE	DESIGN BY:
1	INITIAL	06/30/15	TAN

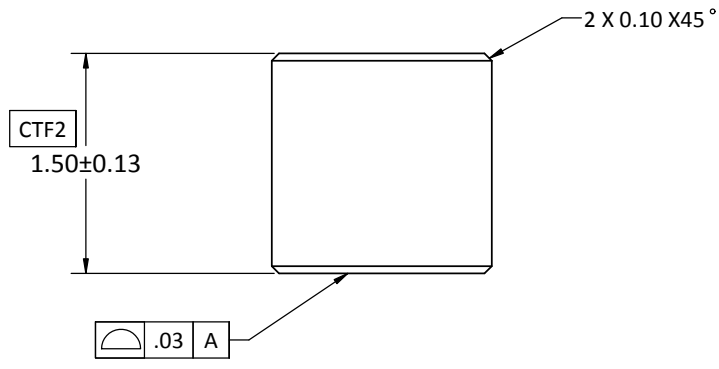
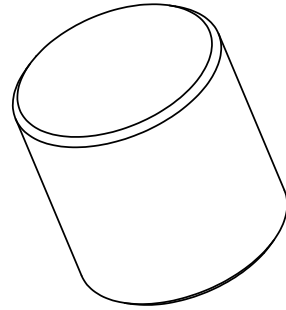
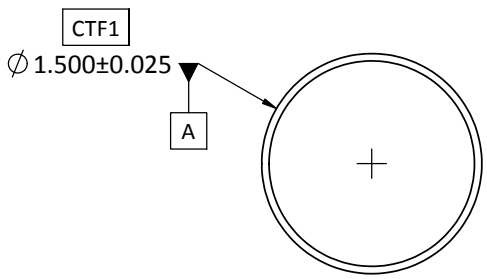

NOTES:(UNLESS OTHERWISE SPECIFIED)

- MATERIAL: C54400 - PHOSPHOR BRONZE.
- PLATE:SULFAMATE NICKEL, 3.5 +/-2.0 um PER ASTM B689-97(2008),  
+ BRIGHT TIN, 5.0+/-2.0 um PER ASTM B545-97(2009).

<p>715 N. PASTORIA AVE. SUNNYVALE, CA 94085 TEL: 408-530-9393 FAX: 408-530-9372</p>	<p>DIMENSIONS ARE IN MM [INCH] .X ± 0.20 [.008] .XX ± 0.10 [.004] .XXX ± 0.025 [.001] ANGLE: NO DEC ± 1° .X ± 0.5° .XX ± 0.25°</p>	<p>MATERIAL: SEE NOTES FINISH: SEE NOTES DRAWN BY: TAN NGUYEN 06/24/2015 CHECKED BY: ENGR APPR: MFG APPR: QA APPR:</p>	<p>TITLE: <b>ALIGNMENT PIN</b> (Ø 1.50 X 1.5 mm LONG)</p>
	<p>THIRD ANGLE</p>	<p>SIZE <b>B+</b></p>	<p>DWG NUMBER: <b>B01-000639</b></p>
SCALE: 12:1		SHEET 5 OF 8	