

- PROPRIETARY INFORMATION -  
NO USE OR REPRODUCTION MAY BE MADE OF  
THIS DOCUMENT WITHOUT EXPRESS WRITTEN  
PERMISSION OF NEOCONIX

REVISIONS			
REV.	DESCRIPTION	DATE	DESIGN BY:
1	INITIAL	09/09/13	TAN
2	REVISE THE PIN LENGTH FROM 0.75 TO 1.0 mm	10/01/13	TAN
3	ADD CTF TO THE DIAMETER	10/28/13	TAN
4	ECN 1120 - ADD CTF TO LENGTH	01/23/14	TAN

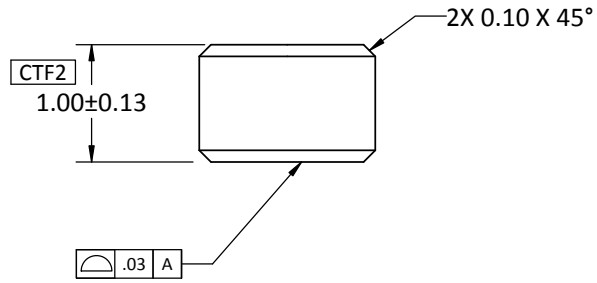
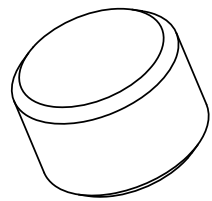
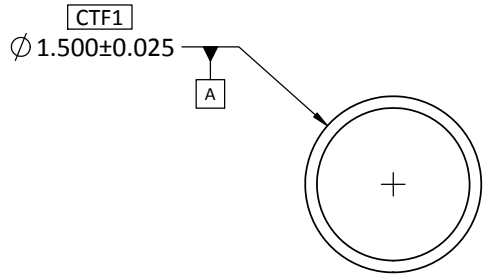

NOTES: (UNLESS OTHERWISE SPECIFIED)

- MATERIAL: C54400 - PHOSPHOR BRONZE.
- PLATE: SULFAMATE NICKEL, 3.5 +/-2.0 um PER ASTM B689-97 (2008), + BRIGHT TIN, 5.0+/-2.0 um PER ASTM B545-97 (2009).

<p>2355-C PARAGON DRIVE. SAN JOSE, CA 95131 TEL: 408-530-9393 FAX: 408-530-9383</p>	DIMENSIONS ARE IN MM(INCHES) X ± .13 XX ± .05 XXX ± .025 ANGLE: NO DEG: + 0.5° X ± .025 XX ± .025		MATERIAL: 1 FINISH: ✓ DESIGN BY: TAN NGUYEN 09/09/2013 CHECKED BY: W MAYNARD 09/09/2013 ENG: MFG: QA:		TITLE: ALIGNMENT PIN (Ø 1.50 X 1.0 mm LONG) DWG NUMBER: B01-000589 SCALE: 10:1 SHEET 1 OF 1	
	SIZE B		REV 4		REV 4	
	SIZE B		REV 4		REV 4	
	SIZE B		REV 4		REV 4	