

## DLP® Connector Overview

### OVERVIEW

The DLP® PCBeam™ Connector is an interconnect solution for the Texas Instruments DLP® chips suitable for ultra-mobile and portable applications. One one-piece, high density and cost-effective solutions are enabled by Neoconix's patented PCBeam™ technology providing both a heat-sink opening and features for precise alignment of the Interposers to the DMD and main PC Board. Latest designs incorporate a bifurcated contact design which enhances the product reliability by providing an aggressive wiping during assembly.

### FEATURES

- Proven High-Performance PCBeam™ contact design
- Connectors are fully compliant to the OEM's reference design drawings
- Both solderless LGA and solderable BGA solutions available
- Current capacity up to 1.5A per position
- Hard gold-plated contact interface
- Compliant with ROHS 2011/65/EU and IPC-4101B (halogen-free)





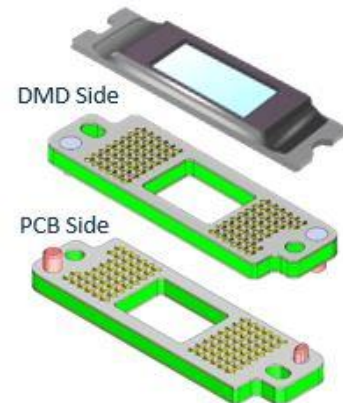



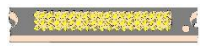

NCX S312 Connector Shown

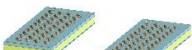

NCX S315 Connector Shown

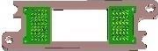
### STANDARD PRODUCT FAMILY

Series Number	DMD Description				Electrical Interconnect Information			
	DLP Number	Array Diagonal	Package	Pad Qty	IO Qty DMD/PCB Type	TI Dwg. Number	Configuration	Neoconix Part Number
S245	<a href="#">DLP3010</a> 7212-3138K	.30 720p	FQK	57	57 LGA/LGA	2513242 (Std-Hgt w/Notch) or		<a href="#">BDX0057CMMF4AU00</a>
						2516242 (Low-Hgt)		<a href="#">BDX0057CMMF4AU03</a>
S246	<a href="#">DLP230GP</a> 5496-2x3BK	.23 qHD	FQP	54	54 LGA/LGA	2515731 (Std-Hgt) or		<a href="#">BDX0054CMMF4AU00</a>
						2516194 (Low-Hgt)		<a href="#">BDX0054CMMF4AU01</a>
S310	<a href="#">DLP4500</a> DLP4500NIR 1191-4xxxC	.45 WXGA	FQD	80	40 LGA/BGA (2 req'd)	2510978		<a href="#">FBX0040CMFF6AU00</a>
S311	<a href="#">DLP4501</a> 1191-4xxxF							
S312	<a href="#">DLP4710</a> 1019-503BM	.47 1080p	FQL	100	100 LGA/LGA	2513791		<a href="#">BDX0100CMMHFAU00</a>
S315	<a href="#">DLP3310</a> 7613-3xxxM	.33 1080p	FQM	92	92 LGA/LGA	2515010		<a href="#">BBX0092CMMHFAU00</a>

1. Compressible Coverlay
2. Over-molded frame
3. New bifurcated contact tip for added reliability
4. In-molded alignment pins

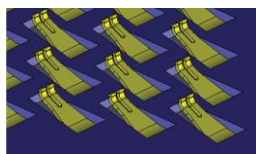

Bifurcated Contact Design

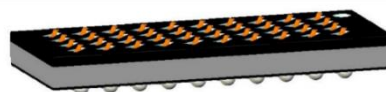

40 pos LGA/BGA Connector

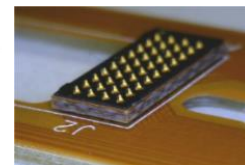

### FOR MORE INFORMATION

Neoconix, Inc., 4020 Moorpark Ave, #108, San Jose, CA 95117. Web: [www.neoconix.com](http://www.neoconix.com) E: [sales@neoconix.com](mailto:sales@neoconix.com) P: 408.530.9393