

- PROPRIETARY INFORMATION -
NO USE OR REPRODUCTION MAY BE MADE OF
THIS DOCUMENT WITHOUT EXPRESS WRITTEN
PERMISSION OF NEOCONIX.

Revisions			
REV	ECN #	Description	Date
3		Modify the outline	01/30/2018
4		Add flatness¶llelism requirement, modify contact TP from 0.150 to 0.152	05/03/2018
5		Add package spec.	05/10/2018

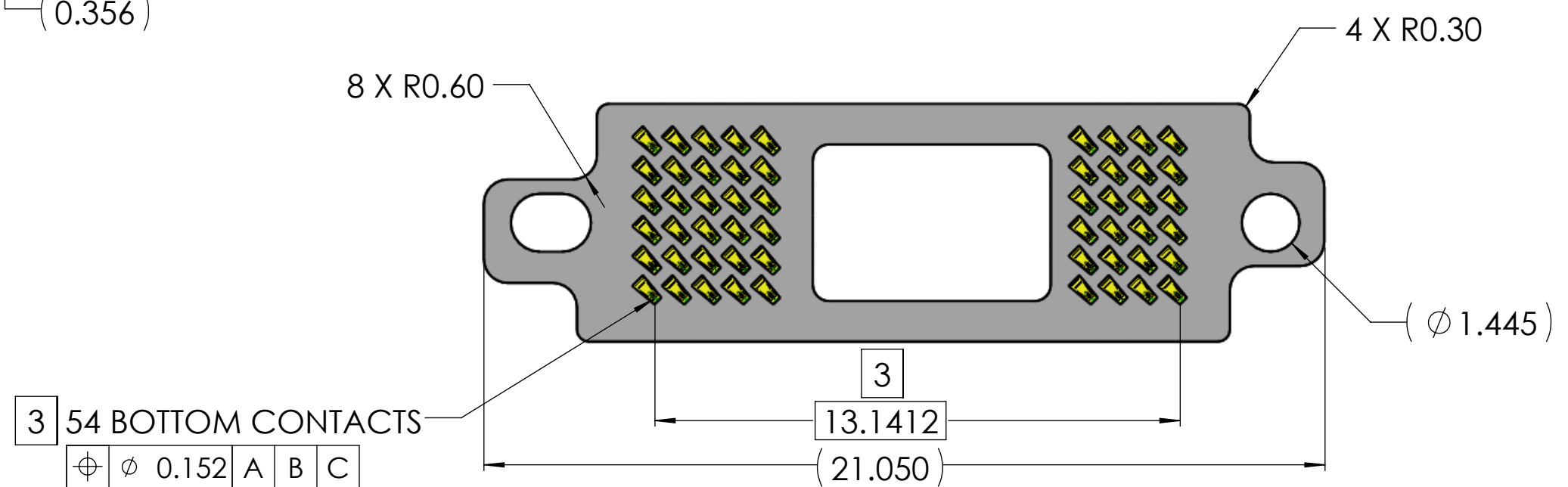
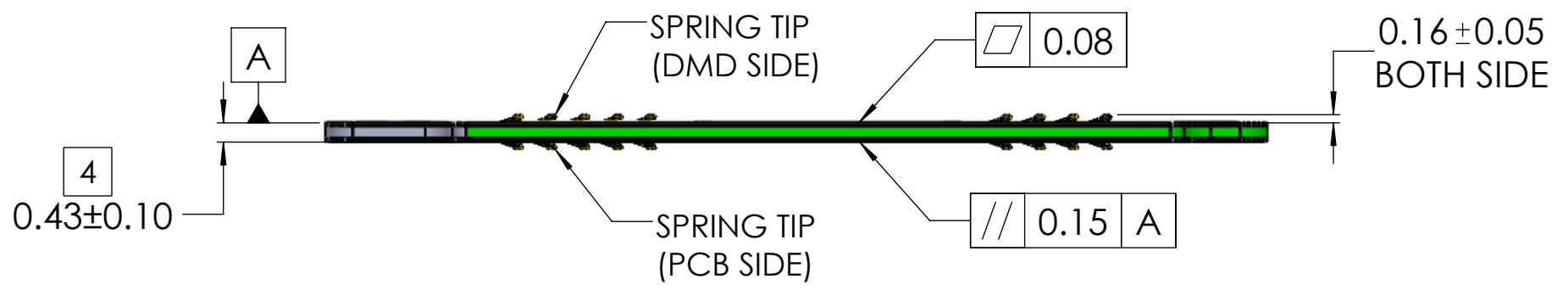
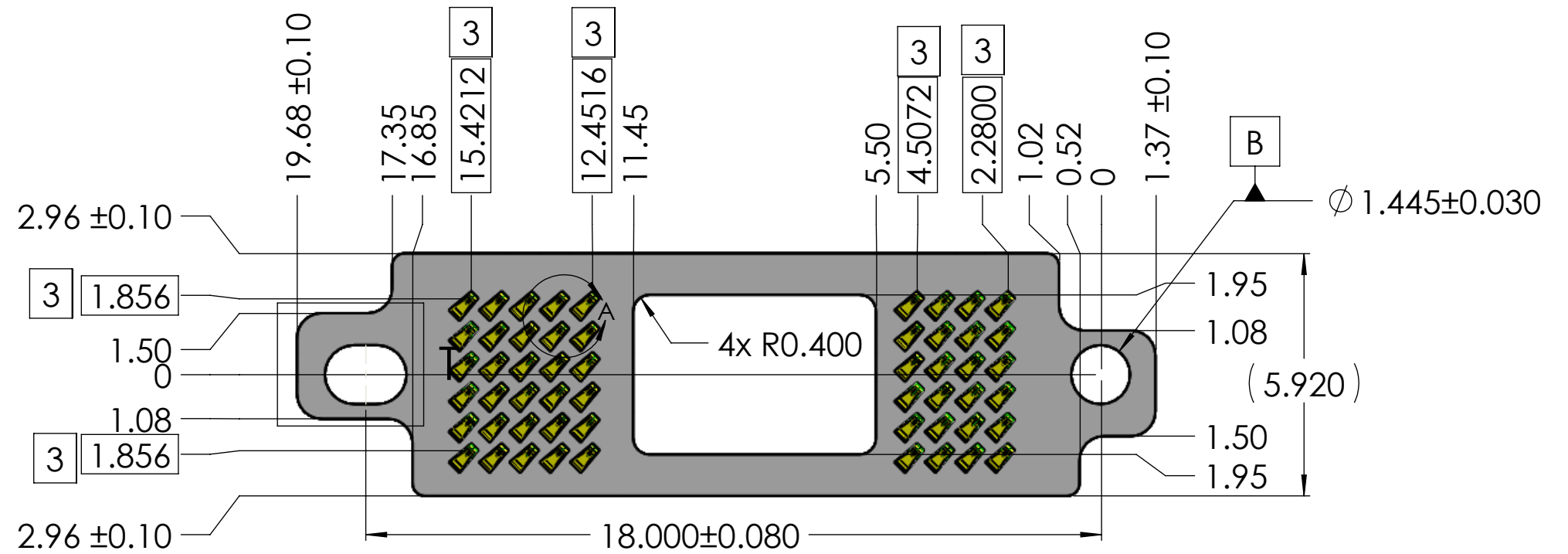
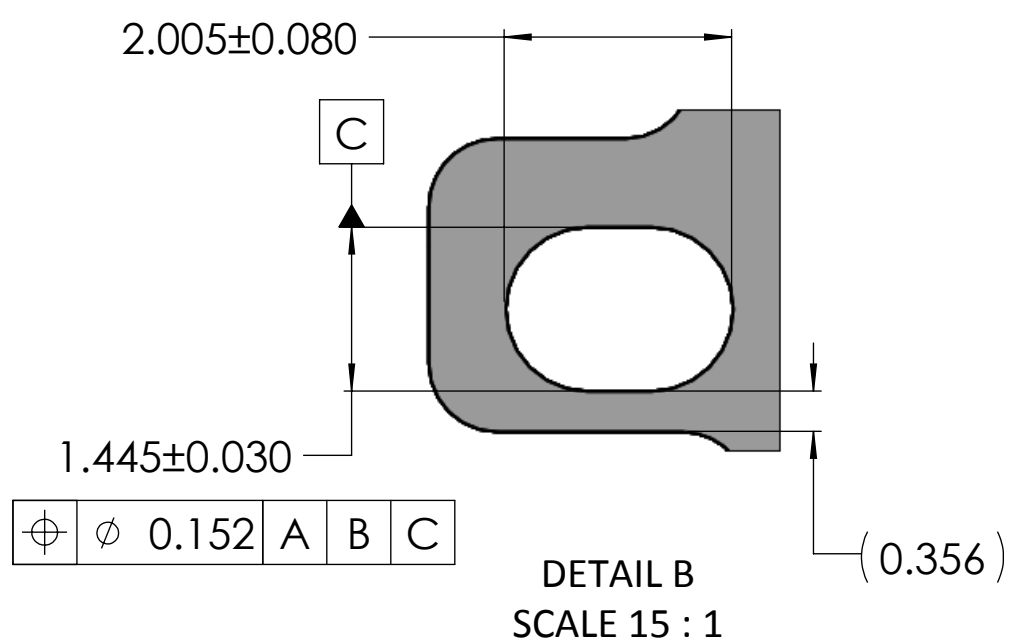
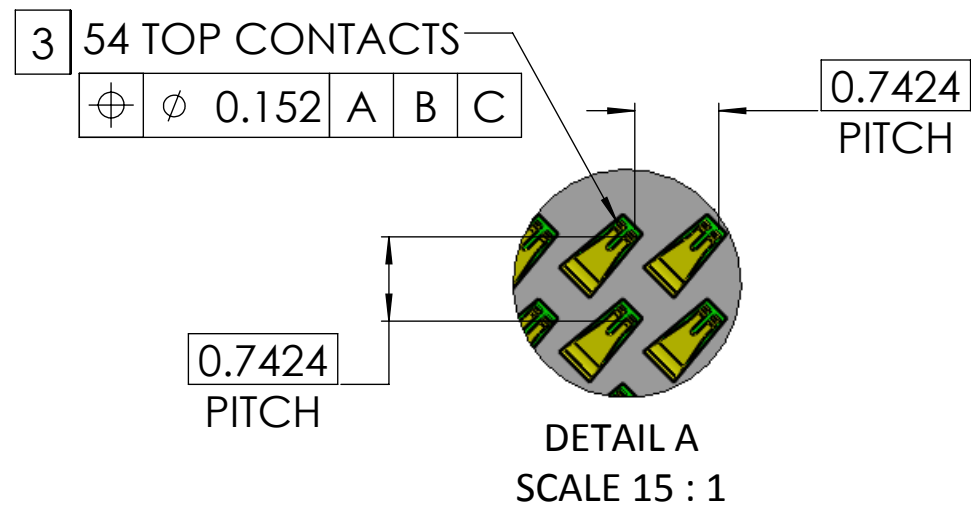

NOTES:(UNLESS OTHERWISE SPECIFIED)

- 1.INTERPRET DRAWING PER ASME Y14.5-94.
- 2.COMPLIANT WITH RoHS DIRECTIVE 2011/65/EU
- 3 .CENTER MARKS OF CONTACT POSITIONS ARE FOR COMPRESSED
- 4 .HEIGHT AT FULLY COMPRESSED CONTACTS

 4020 Moorpark Ave., #108 San Jose, CA 95117 TEL: 408-530-9393 FAX: 408-530-9383	DIMENSIONS ARE IN mm [INCH] .X ± 0.13 [.005] .XX ± 0.08 [.003] .XXX ± 0.025 [.001] ANGLE: NO DEC ± 1° .X ± 0.5° .XX ± 0.25°	MATERIAL: FINISH: DRAWN BY: Y.Z.LI 05/10/2018 CHECKED BY: JIAN YU 05/10/2018 ENGR APPR: Gary Hsieh 05/10/2018 MFG APPR: QA APPR:	TITLE: 54 POS PCBeam INTERPOSER LGA-LGA,0.7424 PITCH DWG NUMBER: BDX0054CMMF4AU01 SCALE: 7:1 SHEET 1 OF 3
		SIZE B+	REV 5
			REV 5
			SHEET 1 OF 3

- PROPRIETARY INFORMATION -
NO USE OR REPRODUCTION MAY BE MADE OF
THIS DOCUMENT WITHOUT EXPRESS WRITTEN
PERMISSION OF NEOCONIX.

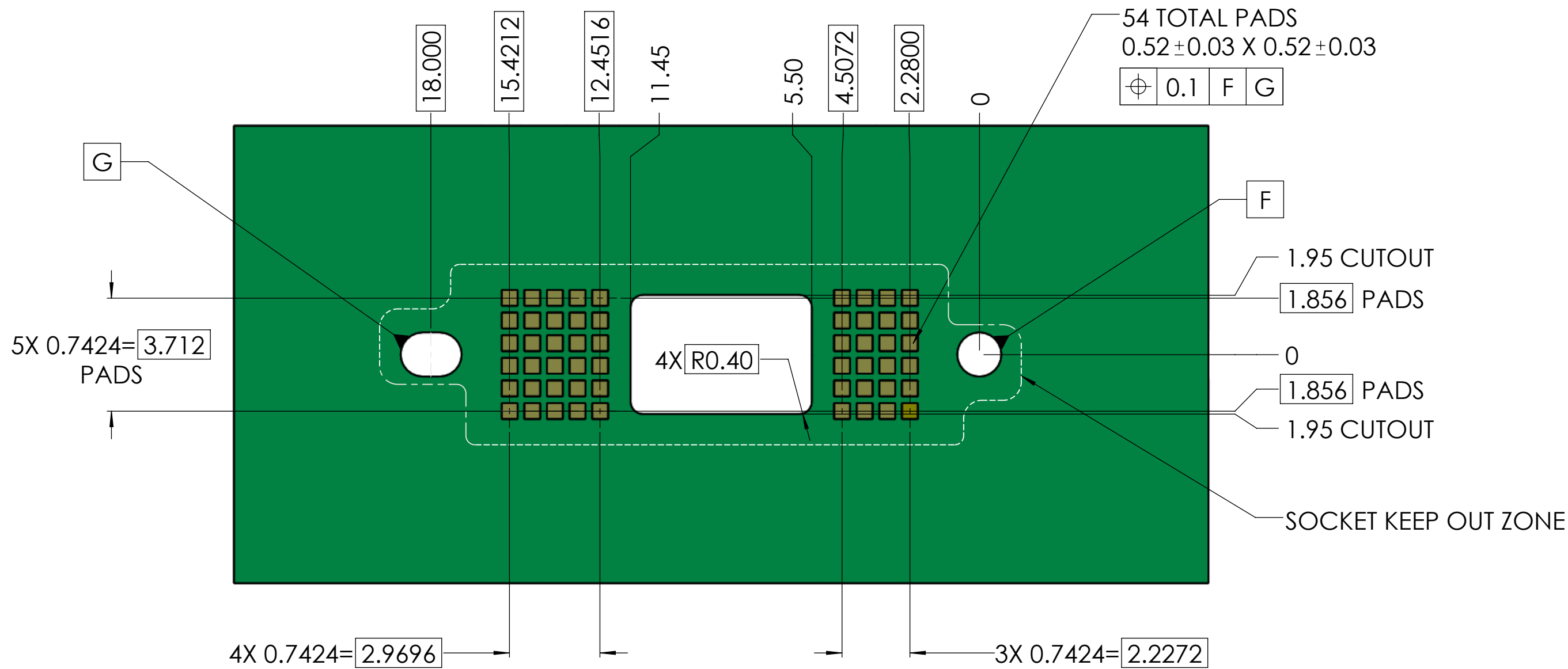

NOTES(UNLESS OTHERWISE SPECIFIED):

- 1.PADS TO BE ELECTROLESS NICKEL/IMMERSION GOLD (ENIG) PLATED
- 2.VIAS IN PAD AREAS MUST BE FILLED
- 3.INTERPOSER OUTLINE; NO COMPONENTS ALLOWED WITHIN THIS AREA
- 4.ALLOWED COMPONENT AREA; MAXIMUM COMPONENT HEIGHT 1.3 mm
- 5.IF SOLDERMASK IS APPLIED IN THE ARRAY AREA. IT SHALL NOT PROTRUDE ABOVE THE PLANE OF THE CONTACT PAD SURFACE

<p>4020 Moorpark Ave., #108 San Jose, CA 95117 TEL: 408-530-9393 FAX: 408-530-9383</p>	<p>DIMENSIONS ARE IN mm [INCH]</p> <p>.X ± 0.13 [.005] .XX ± 0.08 [.003] .XXX ± 0.025 [.001]</p> <p>ANGLE: NO DEC ± 1° .X ± 0.5° .XX ± 0.25°</p>		<p>MATERIAL:</p> <p>FINISH: Gold</p>		<p>TITLE:</p> <p>RECOMMEND PCB FOOTPRINT</p>	
	<p>DRAWN BY: Y.Z.LI 05/10/2018</p>		<p>CHECKED BY: JIAN YU 05/10/2018</p>		<p>SIZE: B+</p>	
	<p>ENGR APPR: Gary Hsieh 05/10/2018</p>		<p>MFG APPR:</p>		<p>DWG NUMBER: BDX0054CMMF4AU01</p>	
	<p>QA APPR:</p>		<p>THIRD ANGLE</p>		<p>SCALE: 7:1 SHEET 2 OF 3</p>	

- PROPRIETARY INFORMATION -
NO USE OR REPRODUCTION MAY BE MADE OF
THIS DOCUMENT WITHOUT EXPRESS WRITTEN
PERMISSION OF NEOCONIX.

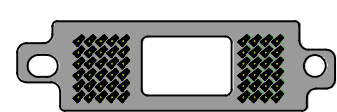
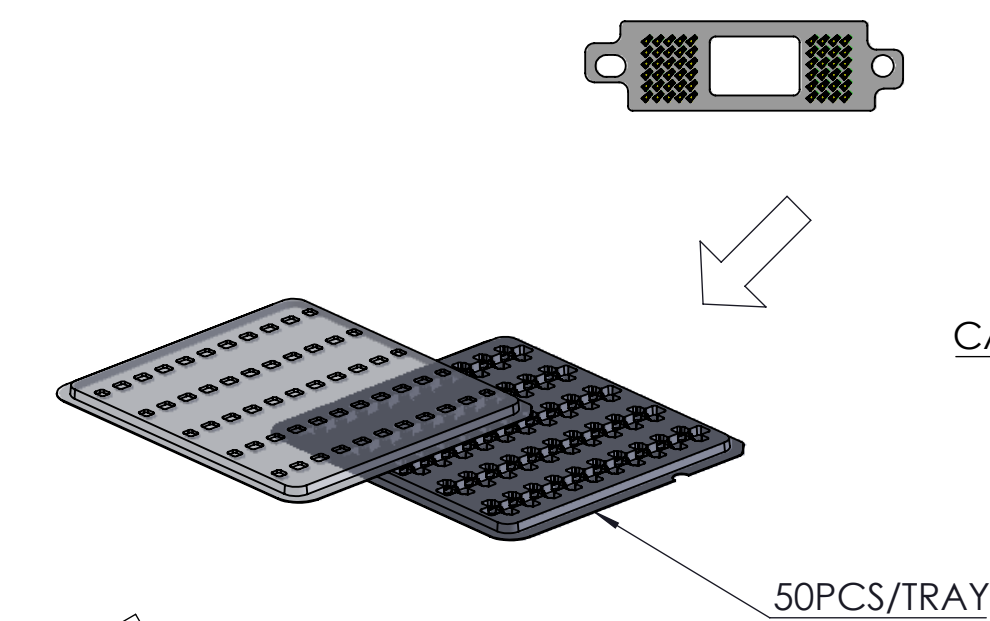

CARTON LABELS

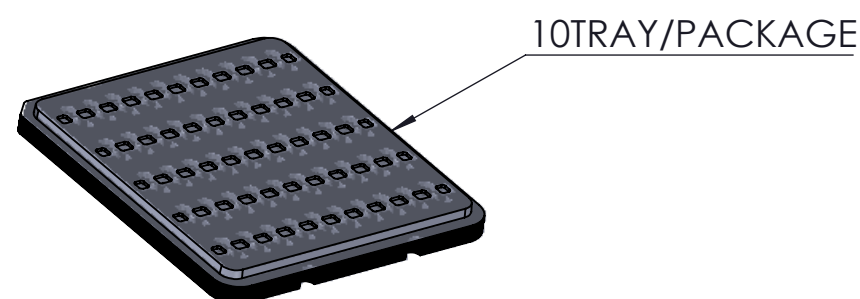
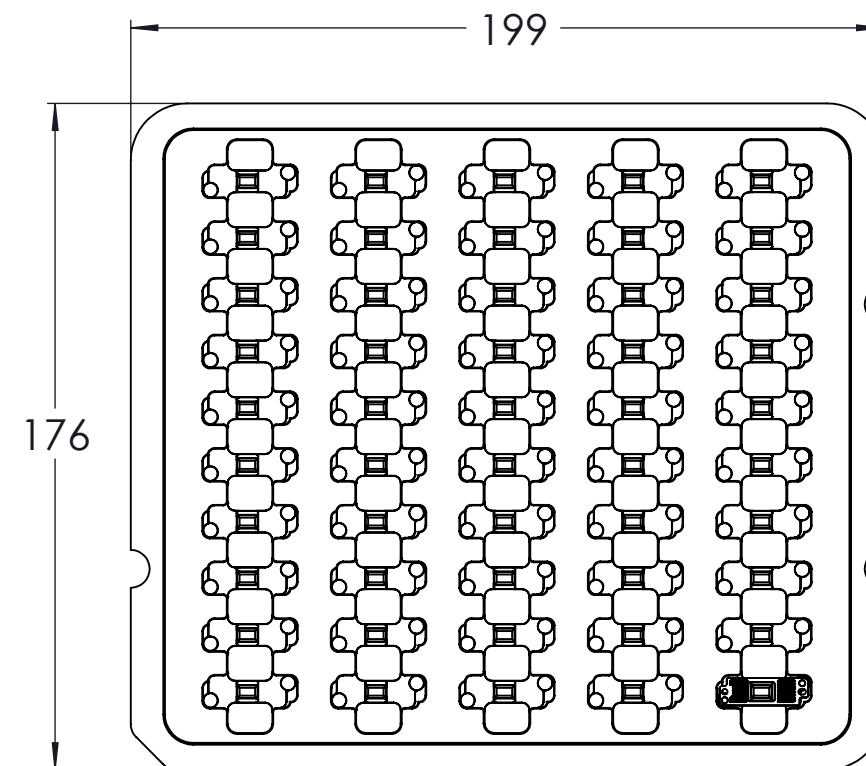
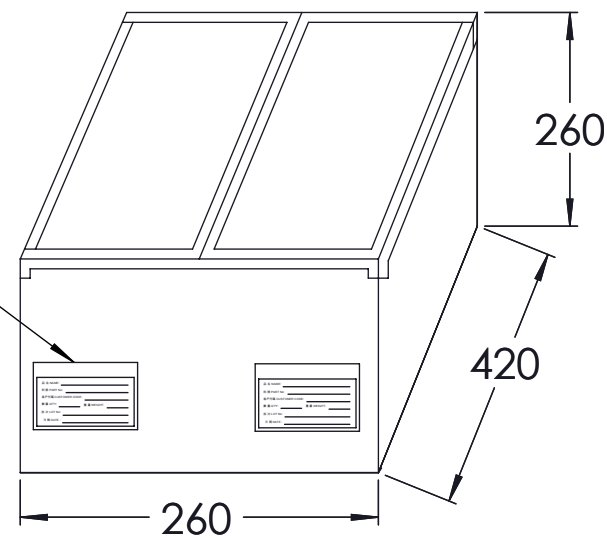

6PACKAGE/CARTON

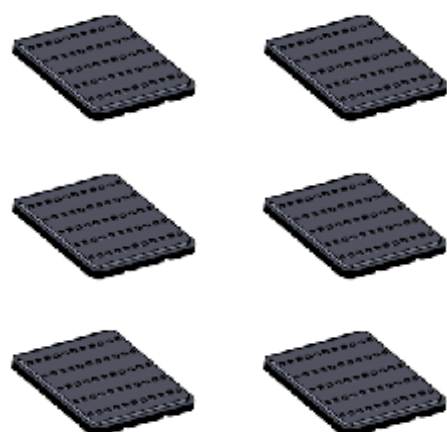
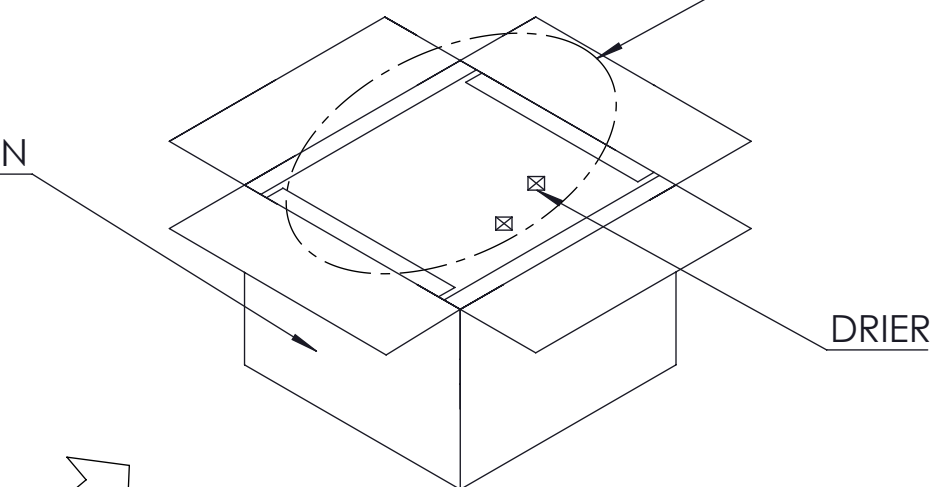

NOTE(UNLESS OTHERWISH SPECIFIED):
1.COMPONENT LOAD PER TRAY : 50PCS
10 TRAY/PACKAGE:500 PCS
6 PACKAGE/CARTON: 420mm X 260mm X 260mm.
TOTAL: 3000PCS/CARTON
2.MATERIAL:TRANSPARENT POLYSTYRENE(PS).

neconix
715 N. PASTORIA AVE.
SUNNYVALE, CA 94085
TEL: 408-530-9393 FAX: 408-530-9372

DIMENSIONS ARE IN
MM [INCH]
.X ± 0.13 [.005]
.XX ± 0.08 [.003]
.XXX ± 0.025 [.001]
ANGLE: NO DEC ± 1°
.X ± 0.5°
.XX ± 0.25°
THIRD ANGLE

MATERIAL: Gold
FINISH: --
DRAWN BY: Yuanzheng Li 05/10/2018
CHECKED BY: Gary Hsieh 05/10/2018
ENGR APPR: Gary Hsieh 05/10/2018
MFG APPR:
QA APPR:

TITLE: PACKAGE SPEC.
SIZE: B+
DWG NUMBER: BDX0054CMMF4AU01
REV: 5
SCALE: 2.5:1 SHEET 3 OF 3